

LOGISTICK

Innovators of Freight Securement Systems™

Complete installation guide for LOGISTICK Loadbar XL™, the one-way solution for securing light- to medium-weight loads.

For best results, please read through all instructions prior to installation.

- 1 Prepare the Surface.** After loading the cargo, determine the best location for installation. This area should place the Loadbar XLs an equal distance from the floor, at a height that allows the beam to be in contact with the freight and allows it to stop the load from starting to move. The entire application area must be clean and dry to ensure proper installation. Using a dry cloth, wipe off all loose dirt and dust from the application area.

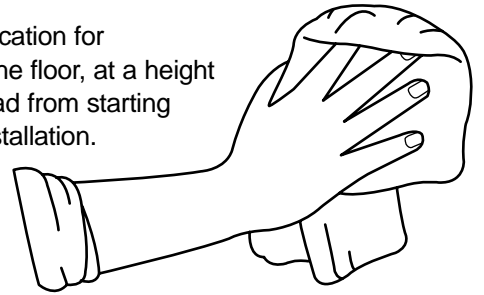

- 2 Prepare the Beam.** The Loadbar XL contains a spring within a pocket and a foam insert under the spring. The spring and insert are designed to apply continuous pressure between a 2x4 and the walls of the trailer. To ensure proper fit and pressure, **the 2x4 should be 3 inches shorter than the inside width of the trailer.**

When installed correctly, the force and pressure of the 2x4, exerted against the spring and foam insert (Fig. 2A), generate an exponential effect of shear strength to the tape backing of the Loadbar XL, making the total unit extremely strong.

Note: A standard 2x4 with a length of 96" works well with trailers that have a 98-1/2" to 102" inside width. Special foam inserts are available from Logistick for use with trailers having 100 1/2" to 102" inside width (Fig. 2B).

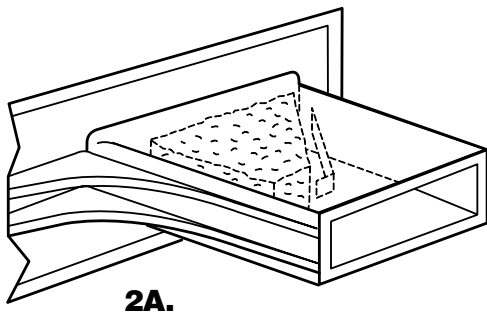

2A.

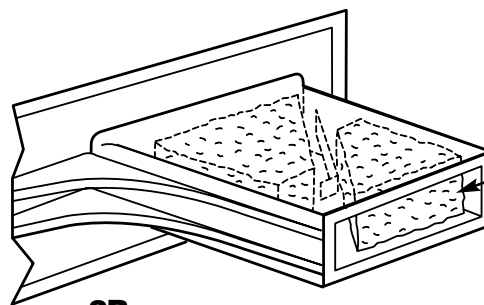

2B. Special foam insert for use with trailers having interior widths of 100 1/2" to 102".

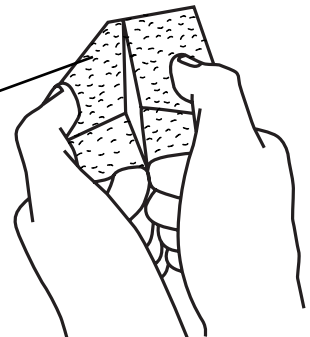

- 3 Setting Up.** Secure one Loadbar XL to its application area and place a correctly sized 2x4 beam into its pocket. Place the second Loadbar XL on the other end of the beam and slide it into its proper position on the wall. Both Loadbar XL handles should point away from the load. The pocket side of each Loadbar XL should be closest to the load.

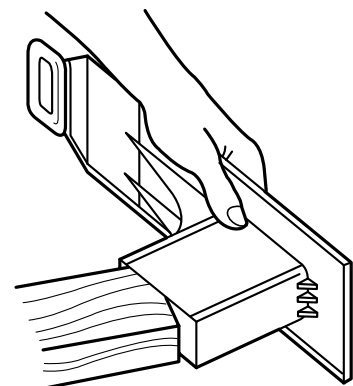

4 Place First Loadbar XL on Wall and Position Second Loadbar XL. Remove the backing from one Loadbar XL. Place this Loadbar XL on one wall in the desired application area, **making sure that the handles are facing toward the rear door of the trailer.**

With its backing still intact, slide the second Loadbar XL into the application area on the opposite wall of the trailer until the beam is level and snug against the cargo. When the 2x4 beam is level and the two Loadbar XLs are in place, correct pressure has been achieved and, upon completion of installation, the entire unit will remain secure between the walls.

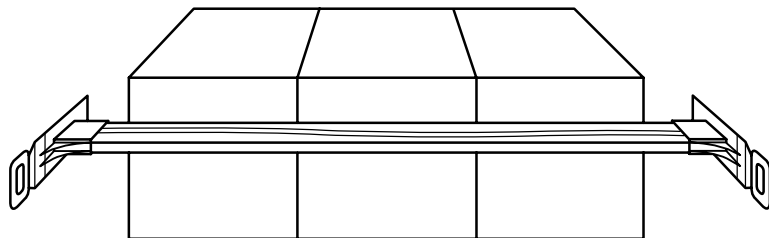

5 Begin Removal of Backing from Second Loadbar XL. Begin by separating the backing from the tape where it is exposed at the cut-out section of the Loadbar XL – just to the rear of the handle. To accomplish this, fold the adhesive portion of the tape forward so that it sticks to the front of the Loadbar XL. Then separate the backing from the adhesive on this section so that the backing is easy to grasp.

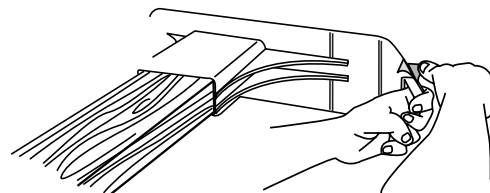

6 Remove Remainder of the Backing. Being careful to maintain the level position of the beam, use one hand to pull the handle of the Loadbar XL slightly toward you, so that the backing is exposed. With your other hand, pull the backing down and to the rear of the Loadbar XL, exposing about the first inch of the backing tape from the rear of the Loadbar XL (Fig. 6A).

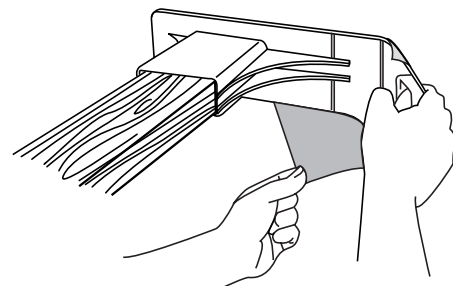

Then, release the handle and gently secure the newly exposed portion of the tape to the trailer wall. Once secure, hold the Loadbar XL in place with one hand and pull the remaining portion of the backing downward and to the rear of the Loadbar XL, making sure the entire tape surface is uncovered and exposed to the wall (Fig. 6B).

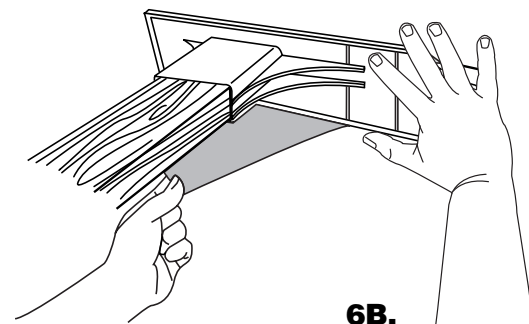

7 Secure the Loadbar XL. When the entire strip of backing has been removed from the second Loadbar XL, press it firmly and squarely against the wall. Repeat this action with the other Loadbar XL, making sure firm and steady pressure is applied. Continue this process until you feel certain the entire surface of each Loadbar XL is fully secured to the wall.

IMPORTANT: Once the Loadbar XL is in position, it should not be moved. Moving the Loadbar XL will weaken the adhesive's initial bond and will reduce the overall performance of the product.

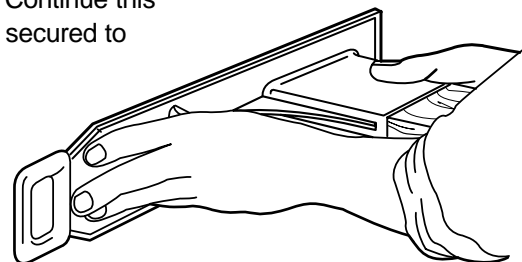

Instructions for Removing the Loadbar XL

I M P O R T A N T

Staple a copy of these instructions to beam to assure safe, easy removal by consignee.

8

Removal of the Beam. One side of each Loadbar XL pocket has scored slots to help with removal of the 2x4. Since each Loadbar XL is designed for either right or left side use, one scored surface will always be available to you. Locate this exposed, scored pocket, weaken the scores with a utility knife and break it open using a screwdriver, claw hammer or pry bar. Lift the 2x4 from the pocket.

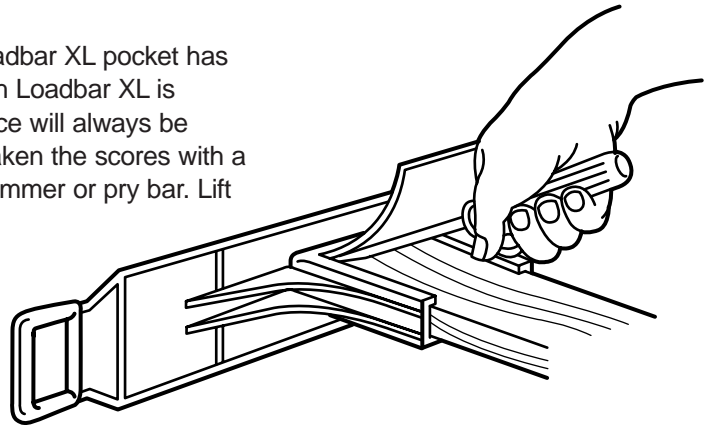

9

Removal of the Loadbar XL. Using the handle, pull the Loadbar XL down and to the rear to remove it from the wall.

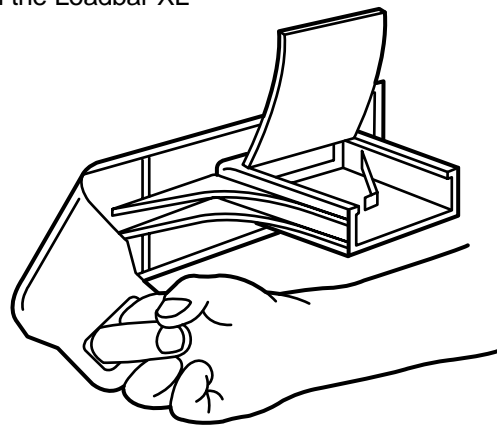

Give the Loadbar XL Extra Strength and Security by Adding the "T" System!

For superior strength, the "T" System can be assembled in combination with the Loadbar XL. The "T" applies pressure to the top of the pocket section of the Loadbar XL and to the wall, creating a high-tension "T" beam across the back of the freight. The additional "T" sections can be secured with nails to the original 2x4 beam used in the installation of the Loadbar XL. This should always be done using the Loadbar XL in the horizontal position, with the handles pointing toward the rear door of the trailer.

Place the two halves as shown in Figure 10A; then push down against the original 2x4 and nail into position.

Be sure the Loadbar XL is secure and in place with the handles pointing away from the load. Once the Loadbar XL is secure and in place, insert two additional pieces of 2x4 stock whose combined length is at least 1 inch greater than the inside width of the trailer, as shown in Fig. 10A. Then, push both of the additional pieces down together against the original 2x4 beam and nail in place.

10A.

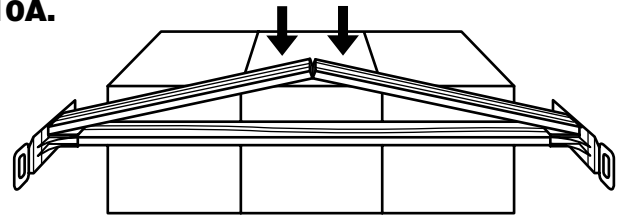

10B.

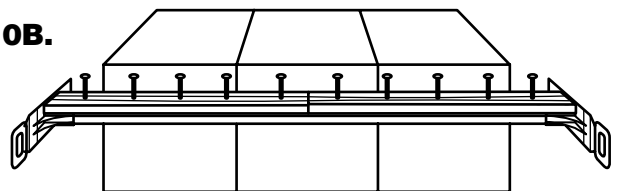

Press the two additional pieces down against the original 2x4 beam and secure with nails.

10C.

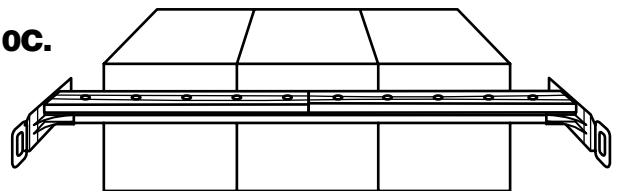

Finished product, nailed in place.



Innovators of Freight Securement Systems™

www.logistick.com

19880 State Line Road • South Bend, IN 46637-1545
1.800.758.5840 • 574.271.2565 • FAX 574.271.2574

WARNING: This product is not to be used in connection with the transportation of any "hazardous materials" as defined at 49 CFR § 171.8.

Logistick®, Inc. is a registered trademark. The Loadbar XL™ is a trademark of Logistick Inc.

LOGISTICK, INC. warrants its product to be free from any defects in material and workmanship. LOGISTICK'S obligation is limited to furnishing, on an exchange basis, replacement parts which may have been found defective upon LOGISTICK inspection. LOGISTICK assumes no shipping responsibility for replacement parts. EXCEPT AS SPECIFICALLY PROVIDED HEREIN, THERE ARE NO OTHER WARRANTIES, EXPRESSED OR IMPLIED, INCLUDING, BUT NOT LIMITED TO, ANY IMPLIED WARRANTY OF MERCHANTABILITY OR FITNESS FOR A PARTICULAR PURPOSE. In addition, under no circumstance will LOGISTICK, INC. be held liable for any damages or claims, including the losses of profit or business interruption, all of which are hereby expressly waived by the purchaser.